

High Quality Fitted Out Offices

The Hallmark Building, 52-56 Leadenhall Street, EC3



Transport Links

- 0.20 miles from Aldgate
- 0.40 miles from Liverpool Street
- 0.40 miles from Bank
- 0.50 miles from Monument

Lease

New leases are available direct from the Landlord for a term by arrangement up to 11/10/2029.

Rent

£57.50 per sq ft exclusive.

Accommodation

Part 4 th Floor	4,104 sq ft	396m ²	Sept 23'
----------------------------	-------------	-------------------	----------

Rates Payable (2022/23)

Estimated at £21.49 per sq.ft

However, all interested parties should make their own enquiries.

Service Charge

Estimated at £13.81 per sq.ft

VAT

The building has been elected for VAT.

Amenities

- Part 7th and Part 1st Floors to be comprehensively refurbished with a new fit out.
- Impressive Entrance Halls (Leadenhall Street & Fenchurch Street)
- Commissionaire Services
- 5 x refurbished Passenger Lifts
- 24 Hour access and security
- Cycle centre and shower/locker room facilities
- On-Site gym facilities (Fitness First)
- EPC – C55



Newton Perkins

Jonathan Beilin – 07976 392 016
E-mail: jb@newtonperkins.com

Chris Sutcliffe – 07970 831 250
E-mail: crs@newtonperkins.com

Knight Frank

Mike Voller – 07739 763 699
E-mail: mike.voller@knightfrank.com

Newton Perkins LLP, Peek House, 20 Eastcheap, London EC3M 1NP

Newton Perkins for themselves and for the vendors or lessors of this property whose agents they are given notice that:- (1) The particulars are set out as a general outline for the guidance of the intending purchasers and do not constitute part of an offer or contract; (2) All descriptions, dimensions, references to condition and necessary permissions for use and occupation and other details are given without responsibility and any intending purchasers should not rely on them as standards or representations of fact but must satisfy themselves by inspection or otherwise as to the correctness of each of them; (3) No persons in the employment of Newton Perkins has any authority to make or give any representation or warranty whatsoever in relation to this property

Part 1st Floor CGI's

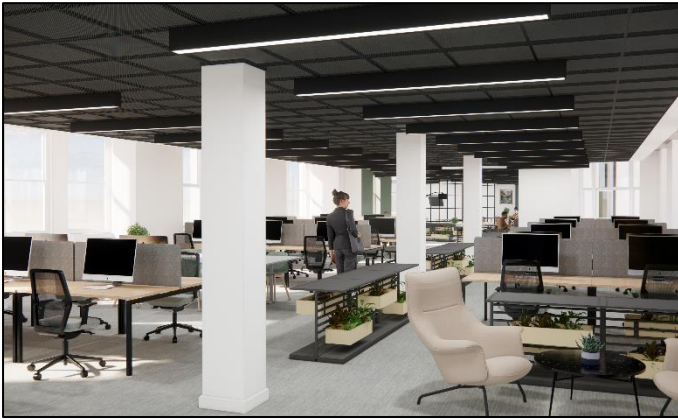

Part 1st Floor Layout